

January 2025

# Installation Guide – MultiFlo 3in1 Tap with C30 Water Filter



**wash water**  
where water has no limits

## Specification

1. Material: 304 Stainless steel
2. Ceramic valve cartridge
3. Flow rate: 8.32pm @ 5bar
4. 3/8" Speedfit Connection for filtered water
5. 1/2" Female Connection for Hot/Cold pipes.

## Installing tools

- \* Adjustable Wrench
- \* Pipe tape
- \* Screwdriver
- \* Electric Drill
- \* Drill Bits

Adjustable Wrench



Pipe tape

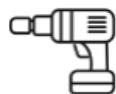

Electric Drill



Drill Bits



Screwdriver

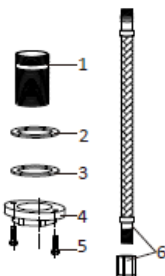
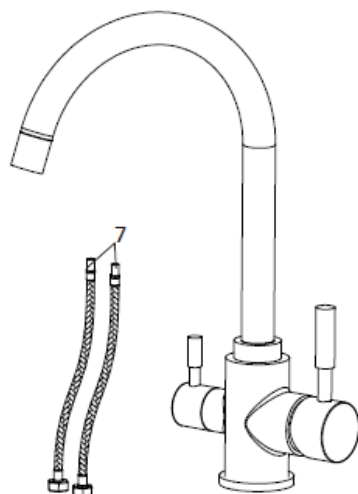
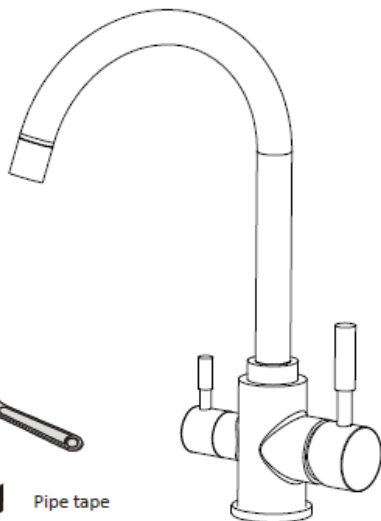

## Accessories

1. 1pc Lock Bolt
2. 1pc Rubber Gasket
3. 1pc Metal Gasket
4. 1pc Lock Nut
5. 2pcs Screw
6. 1pc Filtered Water Hose with Fitting
7. 2pcs Hot and Cold 600mm Hoses

# Profile Drawing

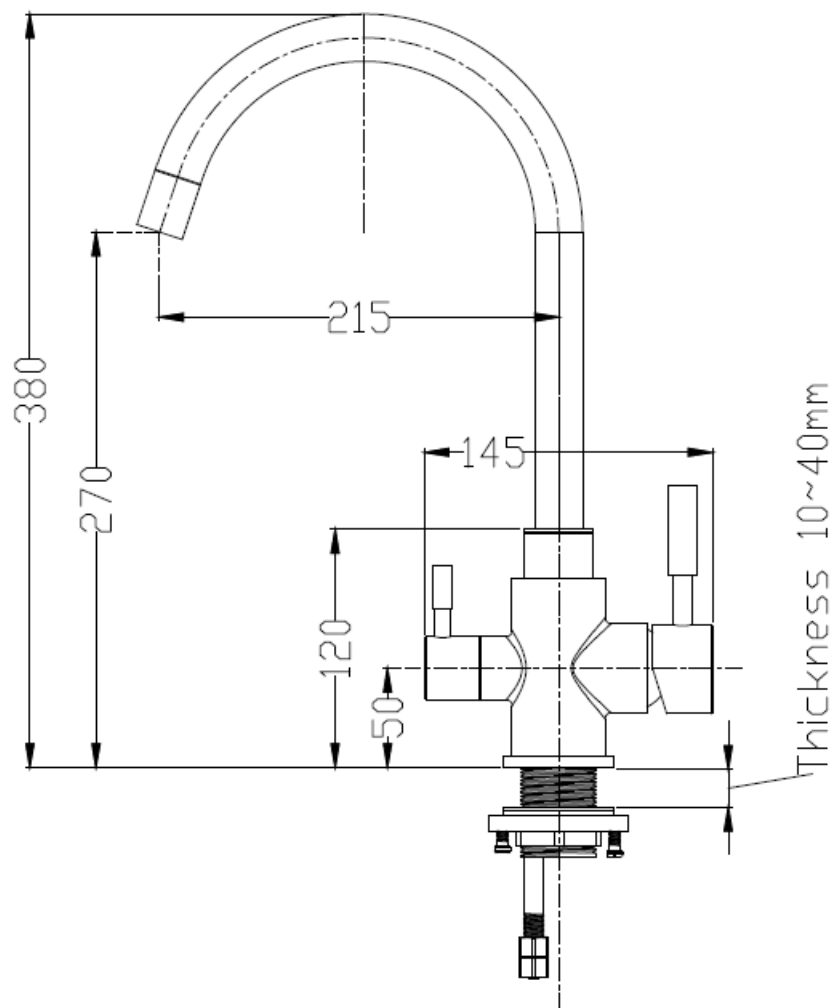

---

## Multi3in Tap Installation

---

1. Choose a suitable location on the sink or worktop. Make sure it is installed on a flat surface.

Once the location has been confirmed, drill a 35mm hole (if required)

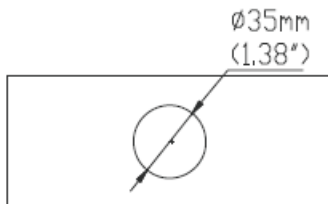

2. Hose connection layout is confirmed below with the water position "mark".

F – Filtered Water

C – Cold Water

H – Hot Water

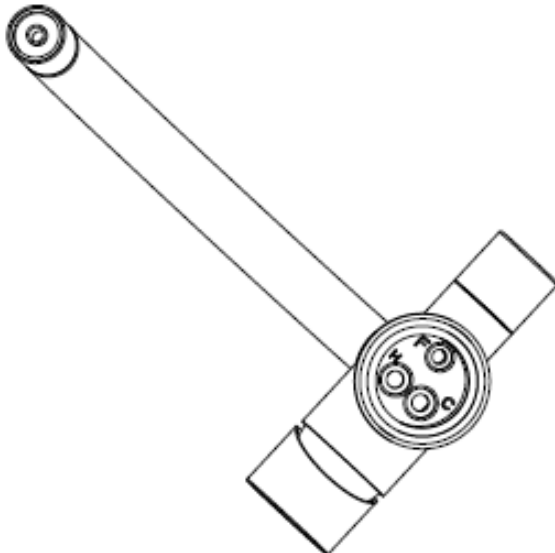

3. Fix the lock bolt to the bottom of the tap. Ensure this is done up tight.

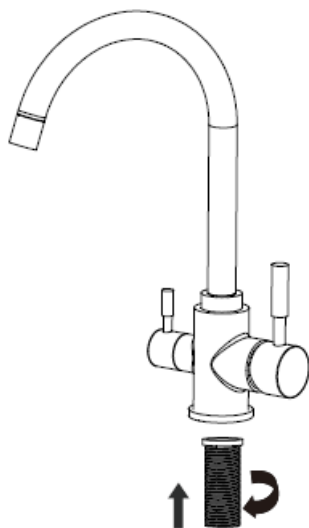

4. Connect the filtered water hose with connector to the bottom of the tap.

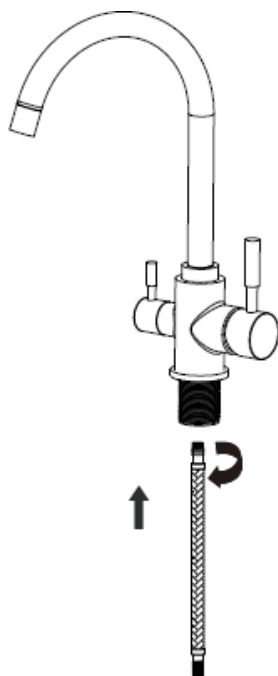

5. Connect the hot and cold hoses to the appropriate holes on the tap (check step 2 to confirm).

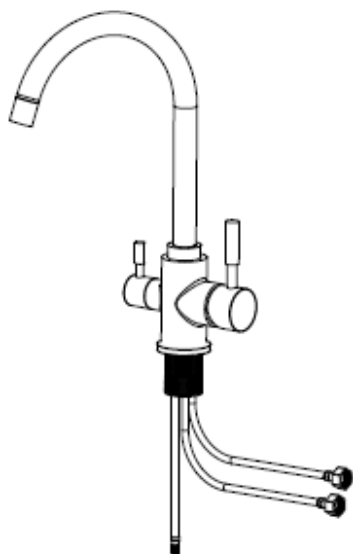

6. Put all the hoses through the drilled hole, and through the rubber gasket (1), metal gasket (2) and locking nut (3). In that order.

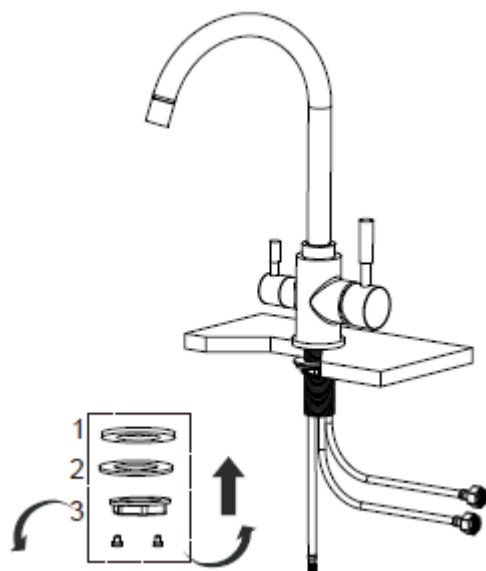

7. Screw the locking nut up the lock bolt to the worktop/sink. Make sure this is tight. Using a screwdriver, tighten the screws to secure in place.

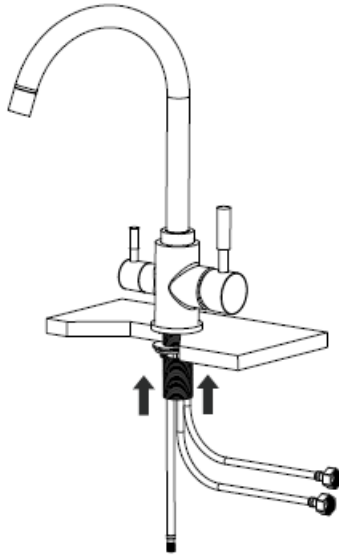

8. Install the 15mm non-return valve on to the cold-water pipe near where the filter will be installed.
9. After the non-return valve, remove a section of the cold water 15mm pipework for the tee fitting to be installed. Install the tee fitting (it is advised to use a bit of sealant on the pipe to help seal the connection). Tighten the nuts to seal.
10. Connect the 15mm x 1/2" fittings to your hot and cold pipes. Tighten to seal. (it is advised to use a bit of sealant on the pipe to help seal the connection)
11. Attach the hot and cold hoses from the tap to the fittings you have just attached. Tighten to seal.

**DO NOT TURN THE WATER ON YET**

---

## *Installation of C30 Filter*

---

1. Choose a suitable location near the tap and mains cold for your C30 water filter to be installed. Make sure there is room beneath the filter to change the cartridge. Recommended 100mm
2. Mark the filter head screw holes, drill the holes and attach the head using the appropriate screws.
3. Twist the filter on to the head, making sure the filter label is front forward with the head.



4. Attach the grey 3/4" Female x 3/8" Speedfit to the tee section of the fitting you have just installed. Tighten to seal.
5. Chamfer 1mm off and grease the 3/8" tubing (supplied) and connect it to the grey fitting. Firmly pressing it in, approx. 1.5cm. Insert C Clip between the collar and the fitting.



6. Cut the 3/8" tubing to length, chamfer 1mm off using a sharp pencil sharpener and grease and insert into the inlet of the filter. Firmly pressing in, approx. 1.5cm. Insert C Clip between the collar and the fitting.



7. Take the remaining 3/8" tubing, chamfer 1mm off using a sharp pencil sharpener and grease one end and insert it firmly into the outlet of the filter, approx. 1.5cm. Insert C Clip.
8. Cut to the required length, chamfer 1mm off and grease then insert into the water filter hose coming from the tap. Firmly insert the tubing, approx. 1.5cm.
9. Turn your cold mains water on. Check for leaks.
10. Open the mains cold water on your kitchen tap. Once water is flowing, close the tap, and check for leaks.
11. Open the mains hot water on your kitchen tap. Once water is flowing, close the tap, and check for leaks.

---

### *Flushing your filter*

---

1. Turn the filtered water on, on the kitchen tap. Water may contain black carbon dust, this is normal.
2. Flush the filter until the water runs clear, for a minimum of 5 minutes.
3. Turn filtered water tap off, check for leaks.
4. You tap installation is now complete.

---

## WASH WATER MULTIFLO 3IN1 GUARANTEE

---

We offer a 5-year parts only warranty on all MultiFlo 4in1 and 3in1 taps from the date of purchase, covering manufacturing and material defects when used as instructed, subject to registering your product within 30 days of purchase. We will replace or repair defective components, but installation and on-site technician costs are not covered. Failure to register your product will result in a 12-month parts only warranty being provided.

**Area Covered** – Great Britain (England, Scotland and Wales)

***This warranty has the following conditions, and is not covered by the following:***

- Incorrect assembly or installation, use of non-recommended parts, or incompatible third-party accessories.
- Tampering or interventions by unauthorised personnel.
- Damage caused by high water pressure. A 5-bar pressure limiting valve is required on the inlet where daytime static water pressure exceeds 3.5bar
- Damage caused by hard or corrosive water.
- Damage or malfunction caused by using the product beyond its specified operating conditions.
- Intentional or unintentional damage caused by the user.
- Damage caused by force majeure events (such as natural disasters, flood etc.)
- Leaks
- Any callouts within the warranty period that are due to external influences affecting the operation of the unit will incur a charge.
- Use of abrasive cleaners to clean the tap. Use clean water only.

The above does not affect your statutory rights.

For Full Terms and Conditions visit our website – [www.wash-water.uk/termsandconditions](http://www.wash-water.uk/termsandconditions)

---

## Cartridge Plans

---

Save time and money and never miss a filter change by signing up to one of our cartridge plans. Contact Wash Water on +44 (0) 1379 873 070 or visit our website [www.wash-water.uk](http://www.wash-water.uk) to see the cartridge plans we have available.